



M. 1:500

343

PWK der WV Oberfischbach

F.W. 12

F.W. 10

O.W. 3

O.W. 1/3

O.W. 5

zulässig

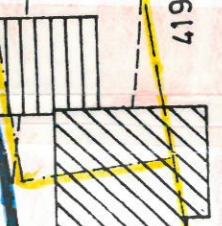
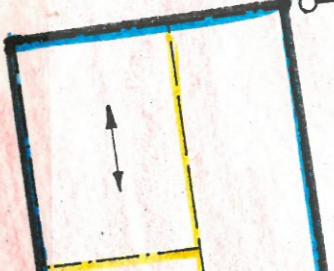
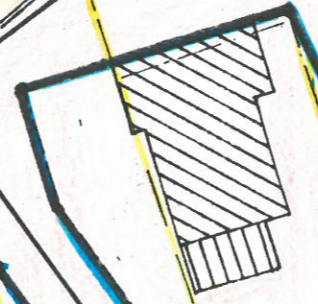
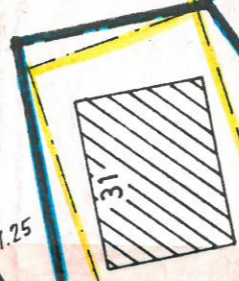
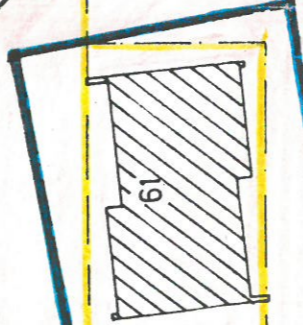
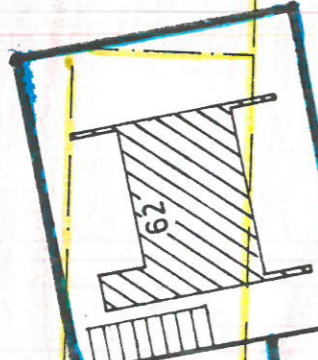

384/2

380/17

423.70

417.63

418.20

424.80

424.80

425.10

424.80

423

422

421

420

418

417

416

416

385

414

413

419

418.20

402

401

397

399

393

389

426

427

424.75

1.25

1.09%

